



SERIES AZ 3672, 3675 & 4675

1/4 INCH METERING VALVES

Ultraclean Springless Diaphragm Design

- Fine adjustment control
12 to 15 turns of the knob
to wide open
- Positive shut off
- Metal seal to atmosphere
- Operating pressure to
145 psig (10 bar)
- Surface finish 10 μ m. Ra
- One wetted moving part
–a diaphragm
- Multi-port options
available
- Stainless steel 316L
construction
- AZ 3672 flow to 10 slpm,
AZ 3675 flow to 40 slpm,
& AZ 4675 flow to 70 slpm
at 30 psig (2 bar) N2
- Installation and operating
instructions available at
www.aptech-online.com
in the Tech Briefs section

Pressure Ratings

Operating pressure	vacuum to 145 psig (10 bar)
Proof pressure	150% of operating pressure
Burst pressure	300% of operating pressure

Other Parameters

Inlet/outlet connectors	1/4 or 3/8 inch face seal or tube weld
Flow coefficient (Cv)	AZ 3672 0 to 0.02 AZ 3675 0 to 0.08 AZ 4675 0 to 0.15
Internal volume	0.06 in ³ (1.07 cm ³)
Operating temperature	-40° to +160°F (-40° to +71°C)
Surface finish	10 μ m. (0.25 μ m) Ra
Inboard leakage	2 x 10 ⁻¹⁰ sccs
Outboard leakage	2 x 10 ⁻⁹ sccs
Leakage across seat	bubble tight (AZ 3672 & AZ 3675 only)

Materials

	Series AZ 3672 and 3675	Series AZ 4675
Wetted Parts		
Body	SS 316L	SS 316L
Diaphragm	Co-Ni-Cr alloy / UNS R30003	Co-Ni-Cr alloy / UNS R30003
Finish	electropolished and passivated	electropolished and passivated
Seat	PCTFE	SS 316L

All specifications subject to change without notice.

THE ULTIMATE IN ULTRACLEAN FLOW METERING

DIMENSIONAL INFORMATION

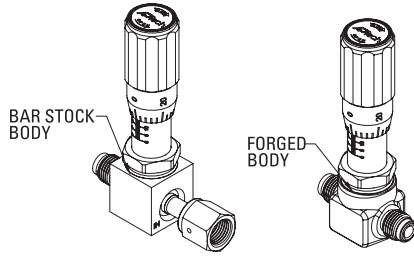
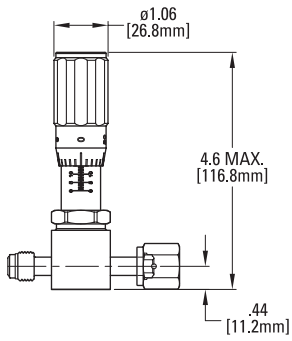

AZ3672 / 3675 / 4675

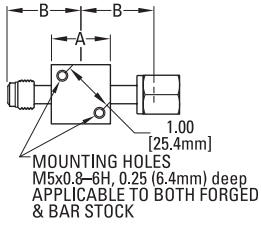

MOUNTING HOLES
M5x0.8-6H, 0.25 (6.4mm) deep
APPLICABLE TO BOTH FORGED
& BAR STOCK

- Metric dimensions are for reference only.
- All specifications subject to change without notice.
- Valves are shown in open position.
- Sulfur content varies from forged to bar stock body.

PORTING CONFIGURATIONS

BODY TYPE	CONNECTION	A		B	
		inch	mm	inch	mm
BAR STOCK	FV4, MV4 (Fixed)	1.12 SQ	28.4	1.390	35.3
	TW4	1.12 SQ	28.4	1.060	26.9
	FV6, MV6	1.12 SQ	28.4	1.930	49.0
	TW6	1.12 SQ	28.4	1.325	33.7
FORGED	MV4xMV4 (Fixed)	N/A	N/A	1.140	29.0
	TW4xTW4	N/A	N/A	0.875	22.2

All dimensions in inches (mm). Metric dimensions are for reference only.

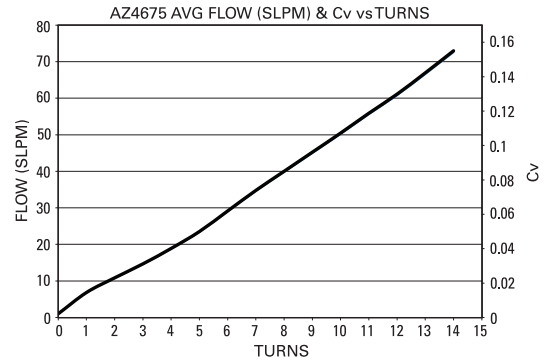
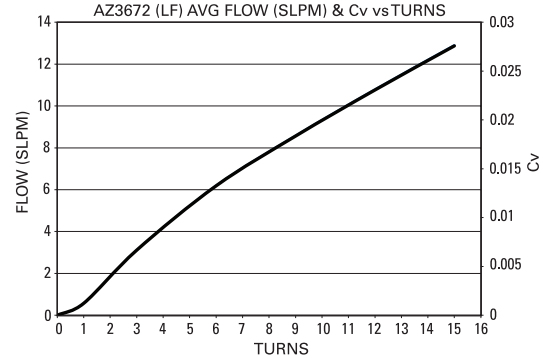
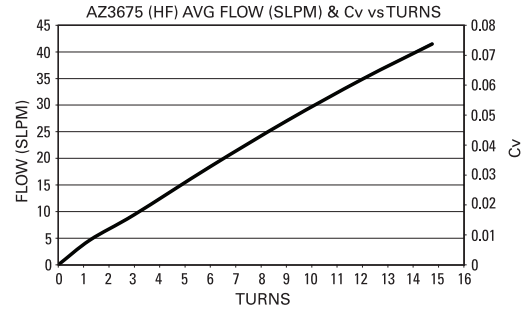

CAUTION: Product selection is the sole responsibility of the user, regardless of any recommendations or suggestions made by the factory. The user shall make selections based upon their own analysis and testing with regard to function, material compatibility and product ratings. Proper installation, operation and maintenance are also required to assure safe, trouble free performance.

ORDERING INFORMATION

Sample Order Number	AZ 3672S 2PW MV4 MV4	
AZ 3672 Series	AZ 3672 AZ 3675 AZ 4675	FV4 FV4 Connections Inlet / Outlet or ① ② ③ ④
S Material	S = Stainless steel (SS)	
2PW Ports	2P = 2 ports 2PW = 2 ports welded 3PW = 3 ports welded 4PW = 4 ports welded	Options 1.75 = 1.75" face to face TW4 PW porting (1.75 is standard for 2P)
Porting Designation Option	X = Letter code for available porting option Refer to porting options in AZ30 data sheet.	

Porting P PW

FV4 = 1/4 inch face seal female	● ○
MV4 = 1/4 inch face seal male*	● ○
TW4 = 1/4 inch tube stub weld	● ○
FV6 = 3/8 inch face seal female	○ ○
MV6 = 3/8 inch face seal male	○ ○
TW6 = 3/8 inch tube stub weld	○ ○

Refer to chart above for available connections.
*MV4 is fixed, no hex nut.

● Only available with the same type fitting inlet and outlet
○ Available with any combination of welded fitting.

AP Tech has product options and variations which are not documented in data sheets. If you have a model number that is not defined by the ordering information, please consult the factory or your local representative.